

concept study - we'd like to hear from you!

Strategies for Nashua Public Library - **Renovation**

As part of its re-imagining, the Library Board of Trustees would like to take your needs and feedback into consideration. Let us know what you think!

instructions

Leave us a sticky note with any feedback you have on this scheme. Then come back and place 'likes' (sticky dots) on the schemes you like the best.

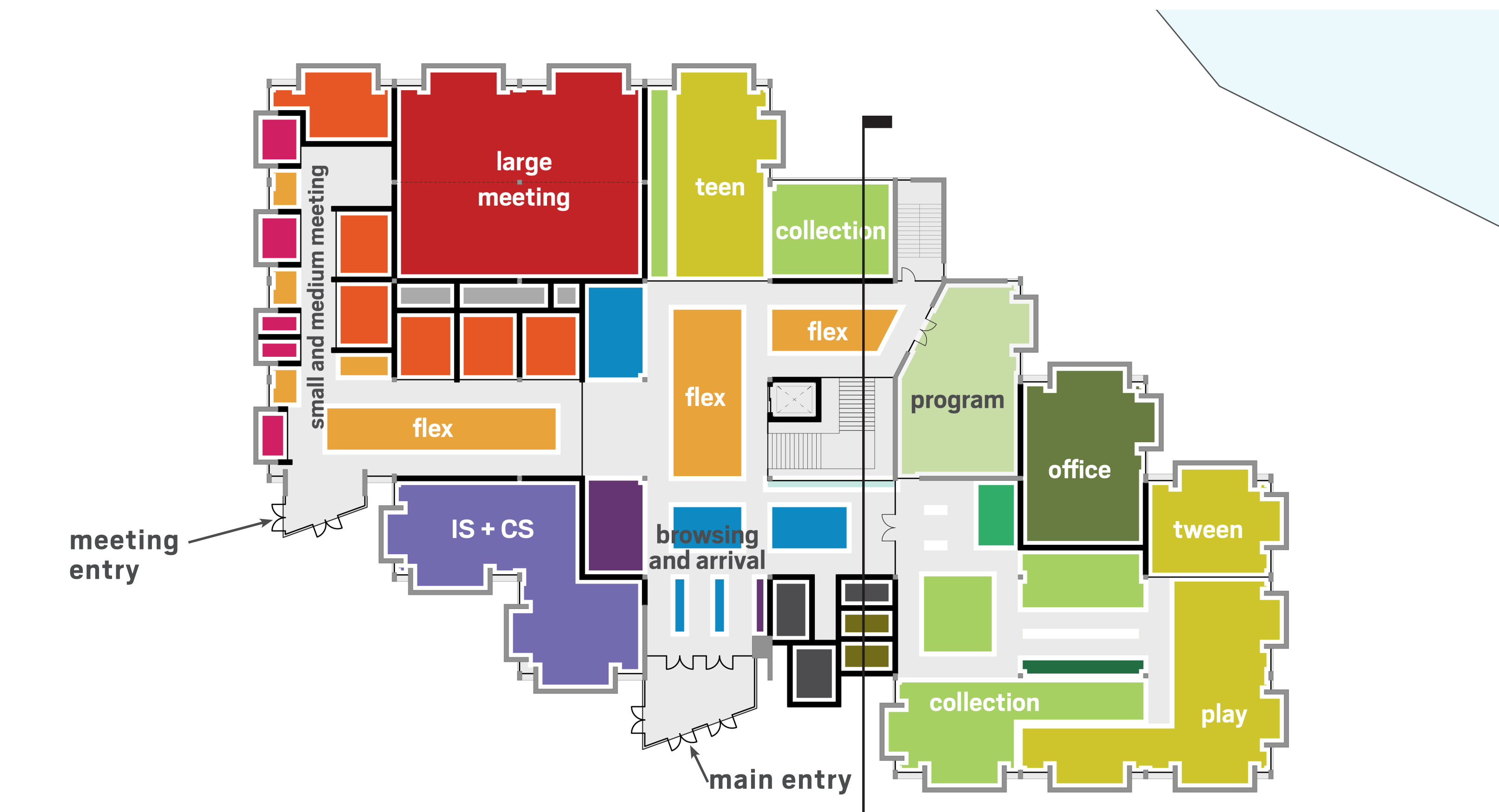

Level 2 (Main Entry)

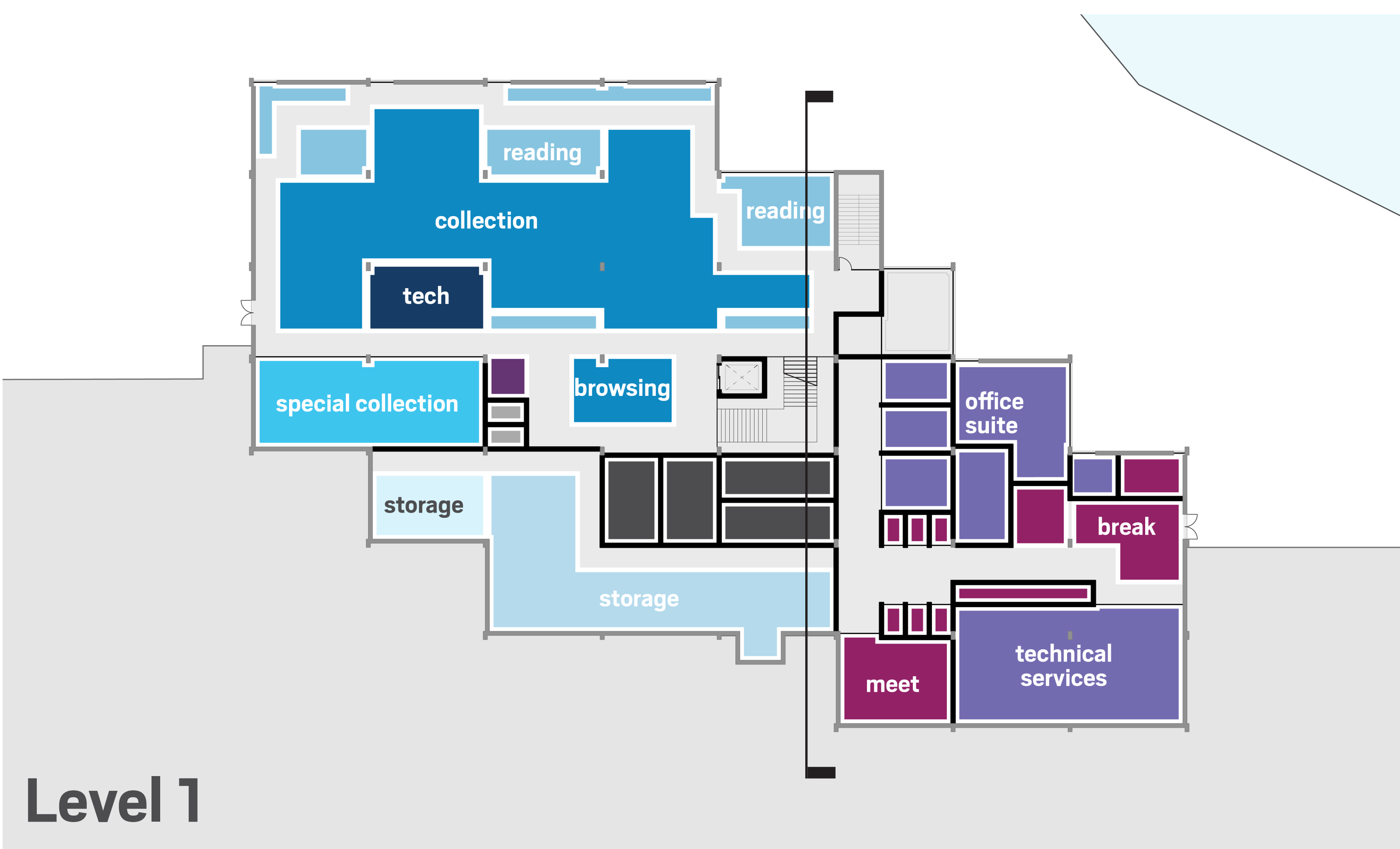

Level 1



Basement

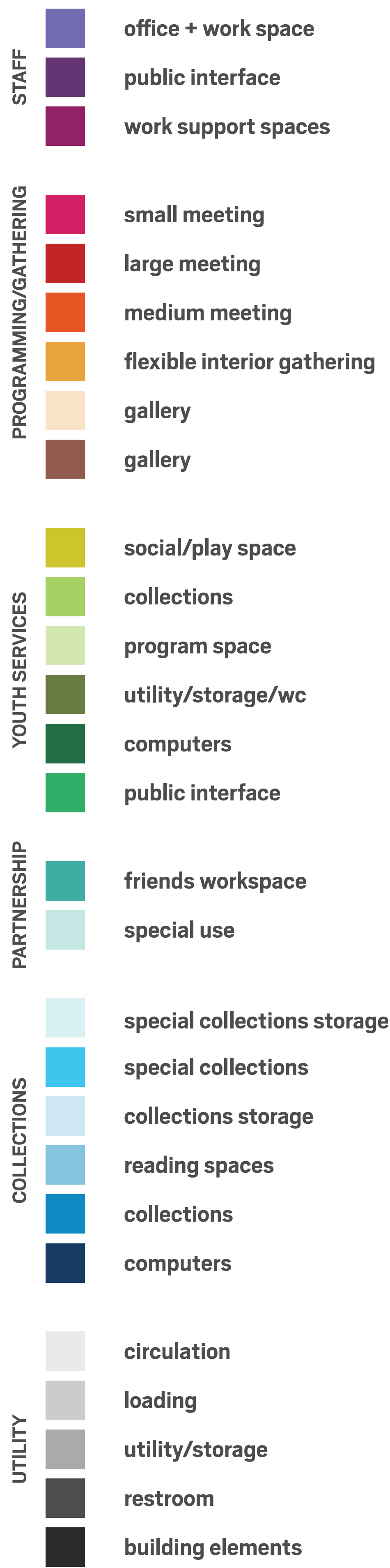

Key Considerations

- Maintain existing building structure (minimize environmental impact)
- Create new exterior building expression (glass + cladding)
- Move meeting + gathering spaces to upper / entry level
- Create new entrances, including a dedicated entrance for meeting spaces
- Expand youth services (including children + teen spaces)
- Create new access at lower / river level
- Create new vertical connection between levels (new stair + elevator)
- Consolidate + improve office spaces

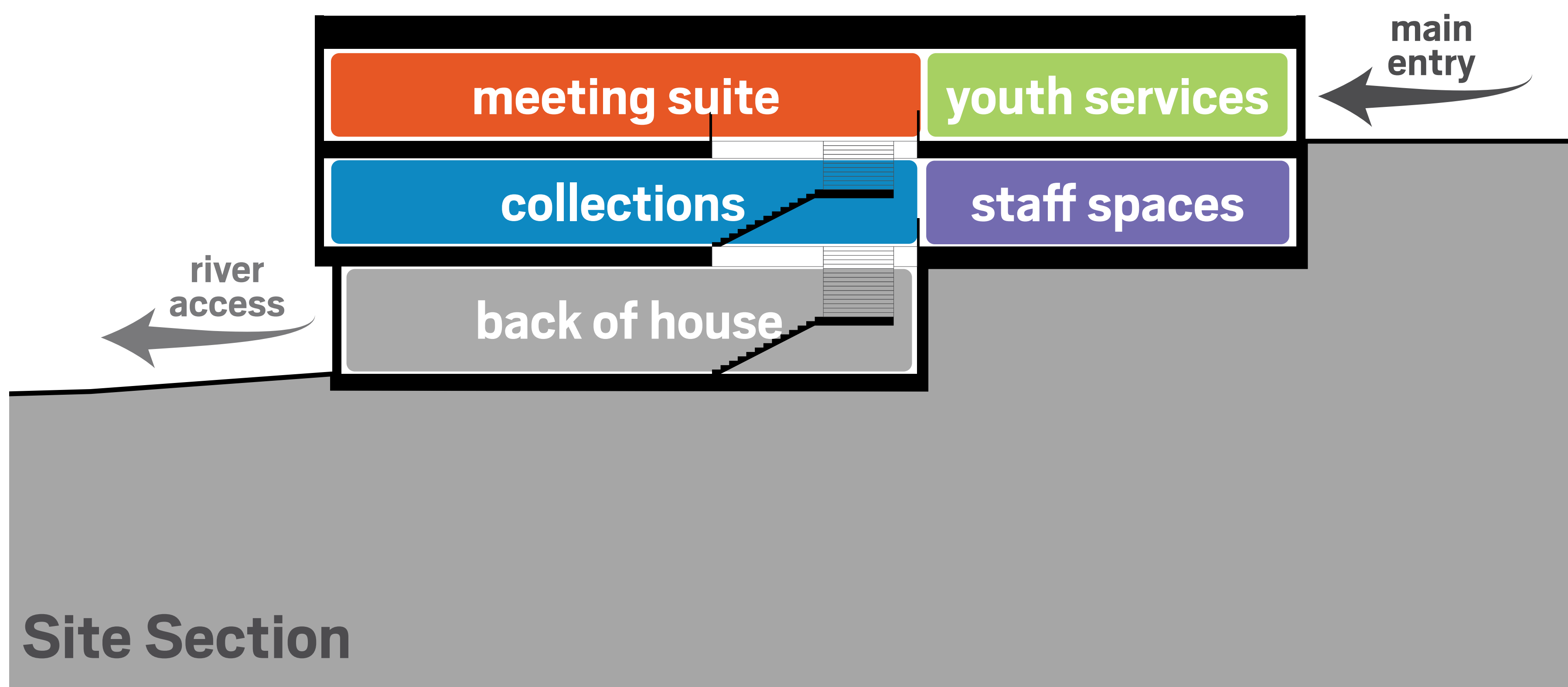

Site Section

feedback

likes

concept study - we'd like to hear from you!

Strategies for Nashua Public Library - Addition

As part of its re-imagining, the Library Board of Trustees would like to take your needs and feedback into consideration. Let us know what you think!

instructions

Leave us a sticky note with any feedback you have on this scheme. Then come back and place 'likes' (sticky dots) on the schemes you like the best.

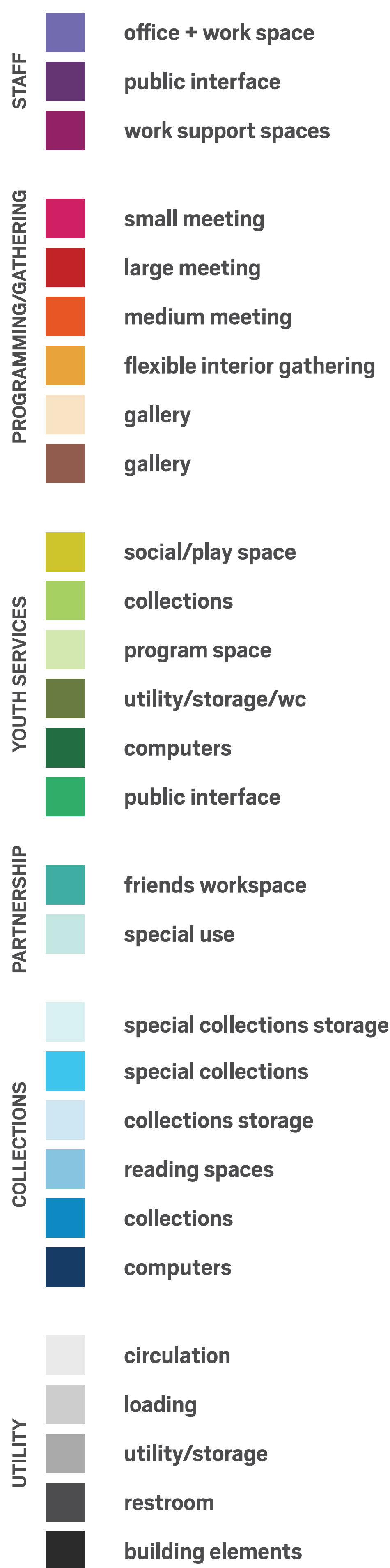
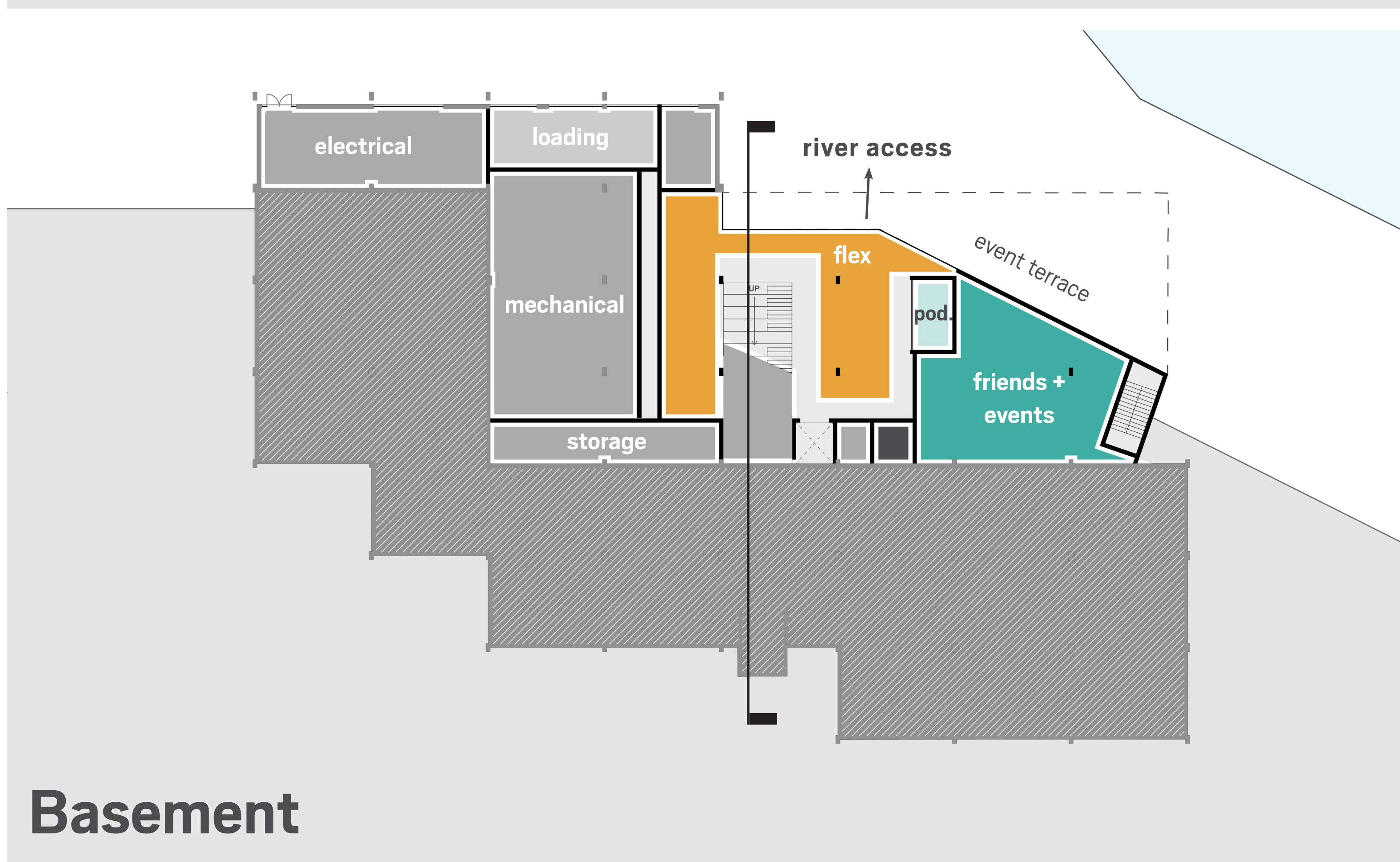
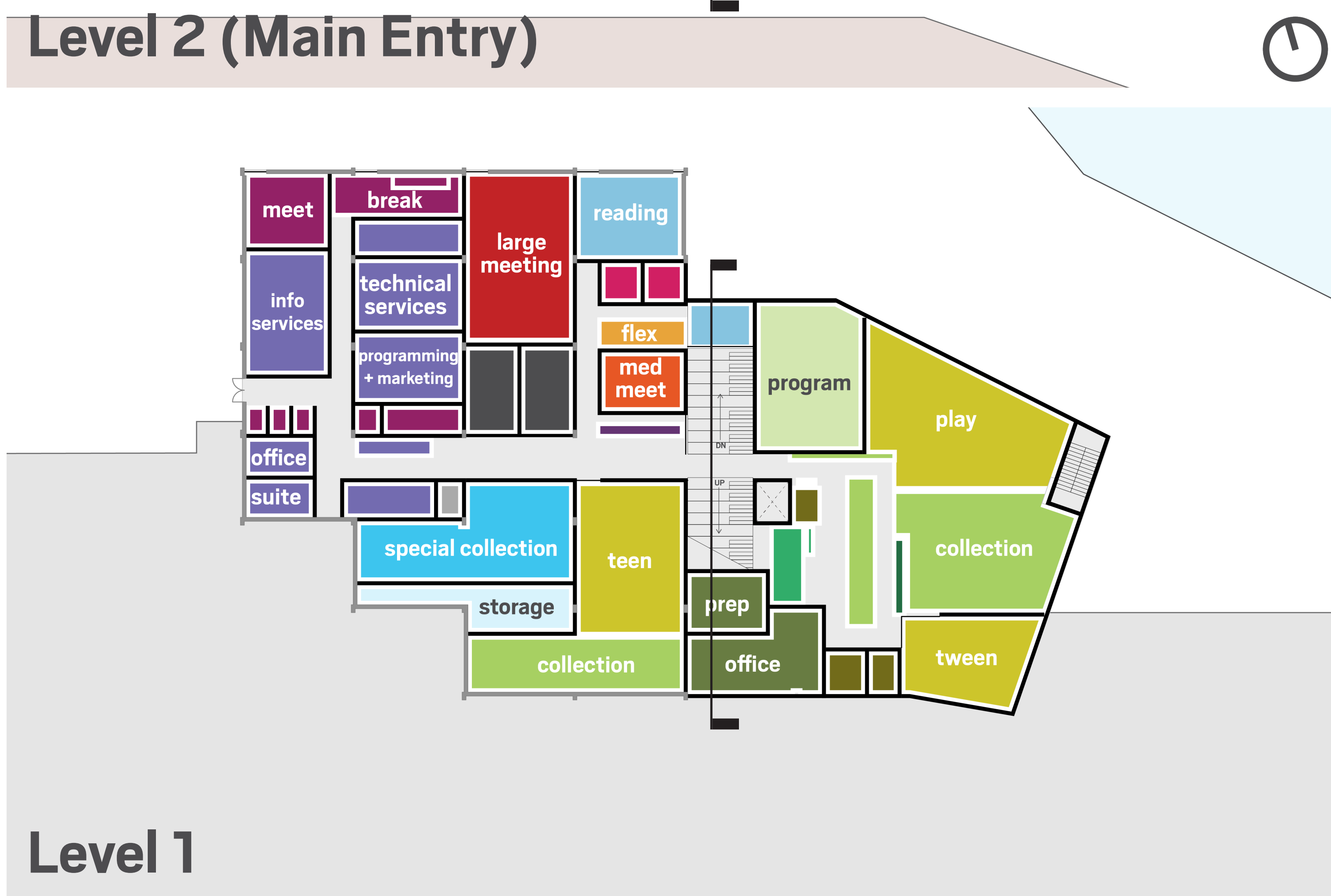
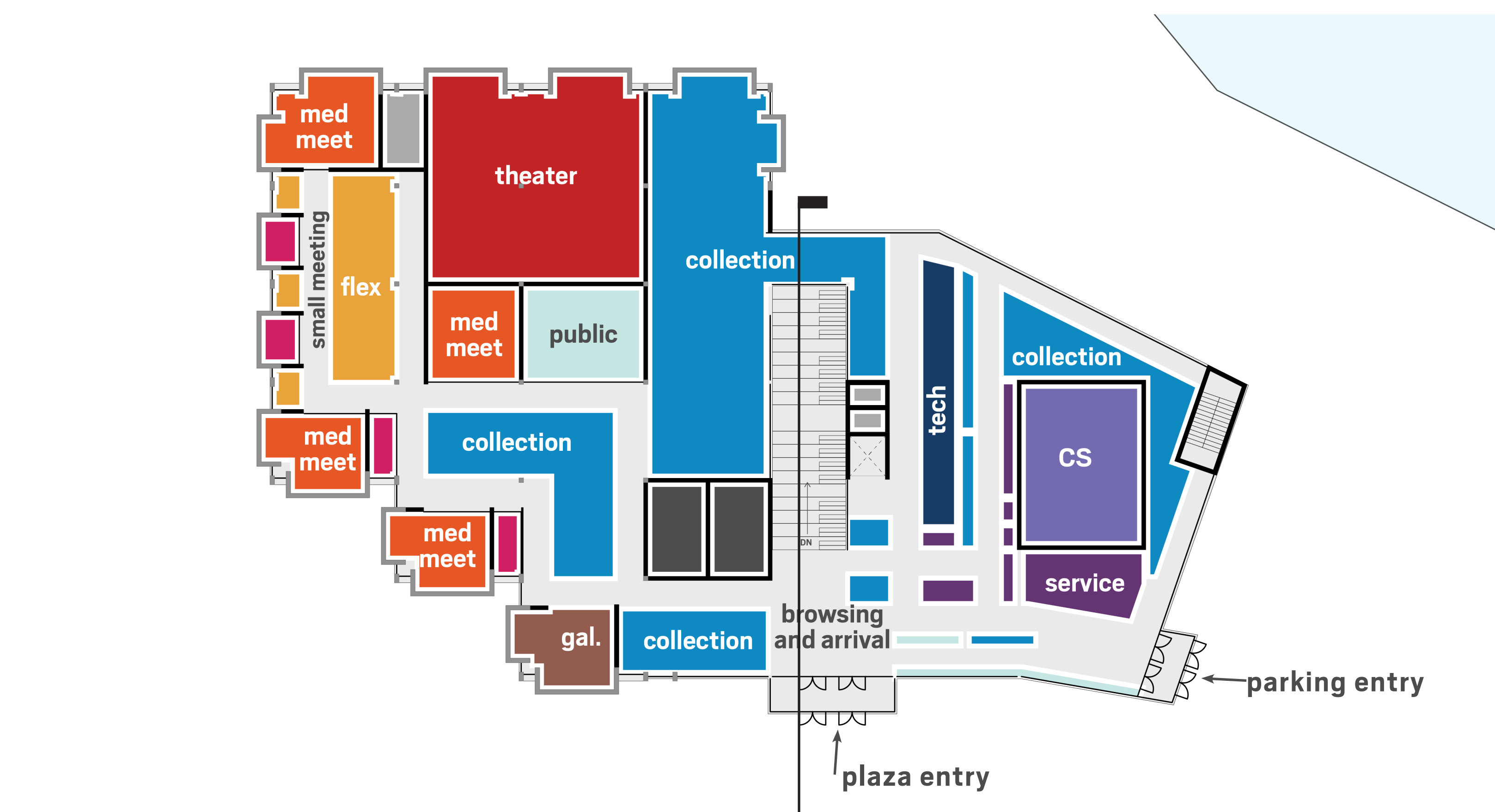

Key Considerations

- Demolish a portion of the existing building and replace with new addition
- New addition creates dual entry sequence from parking lot and plaza
- New addition also creates new exterior building expression (glass + cladding)
- A new monumental stair through the building is introduced to intuitively connect levels
- Youth Services is expanded and located on middle level
- New entrance and program area at lowest / river level
- Dispersed meeting + large gathering spaces

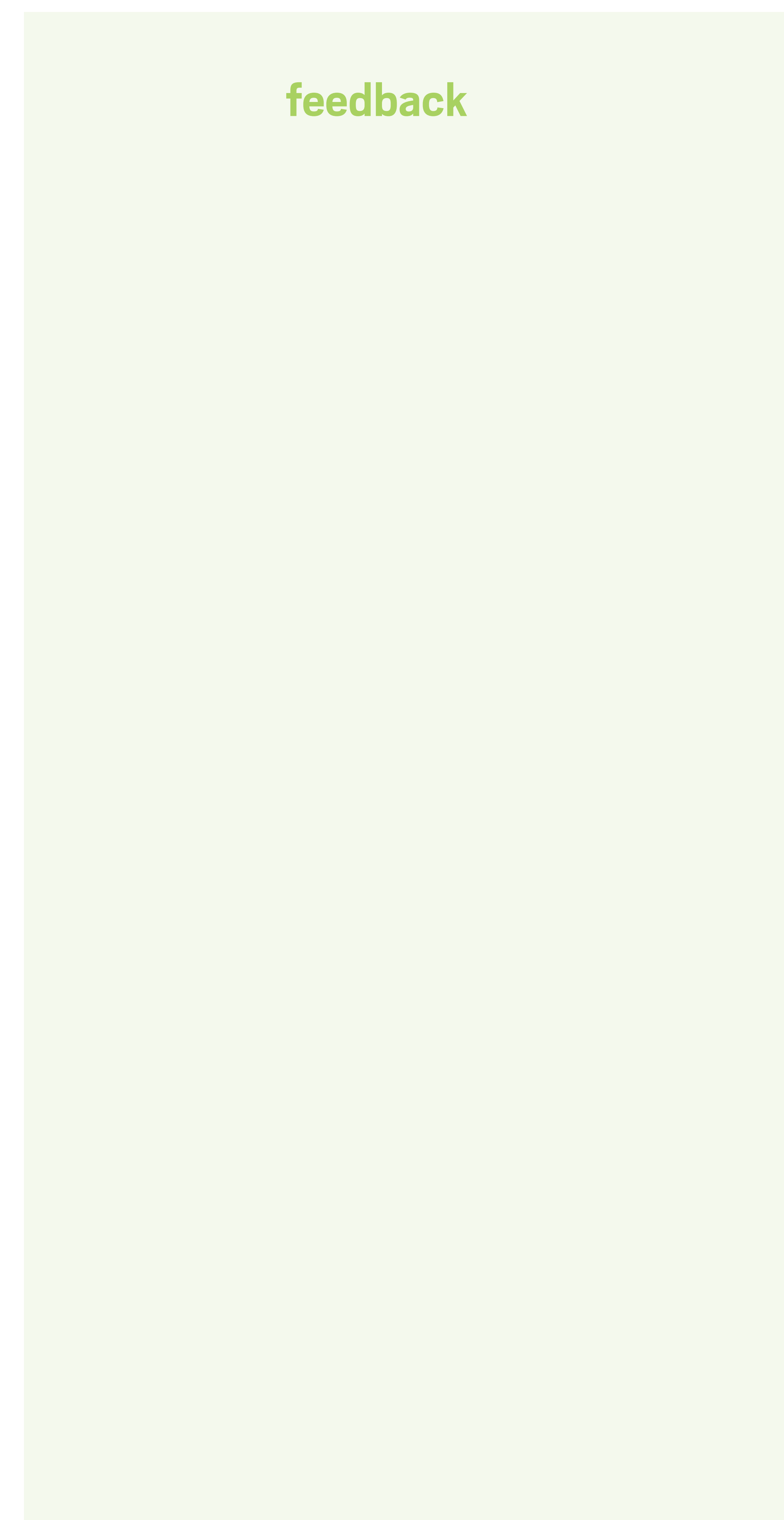
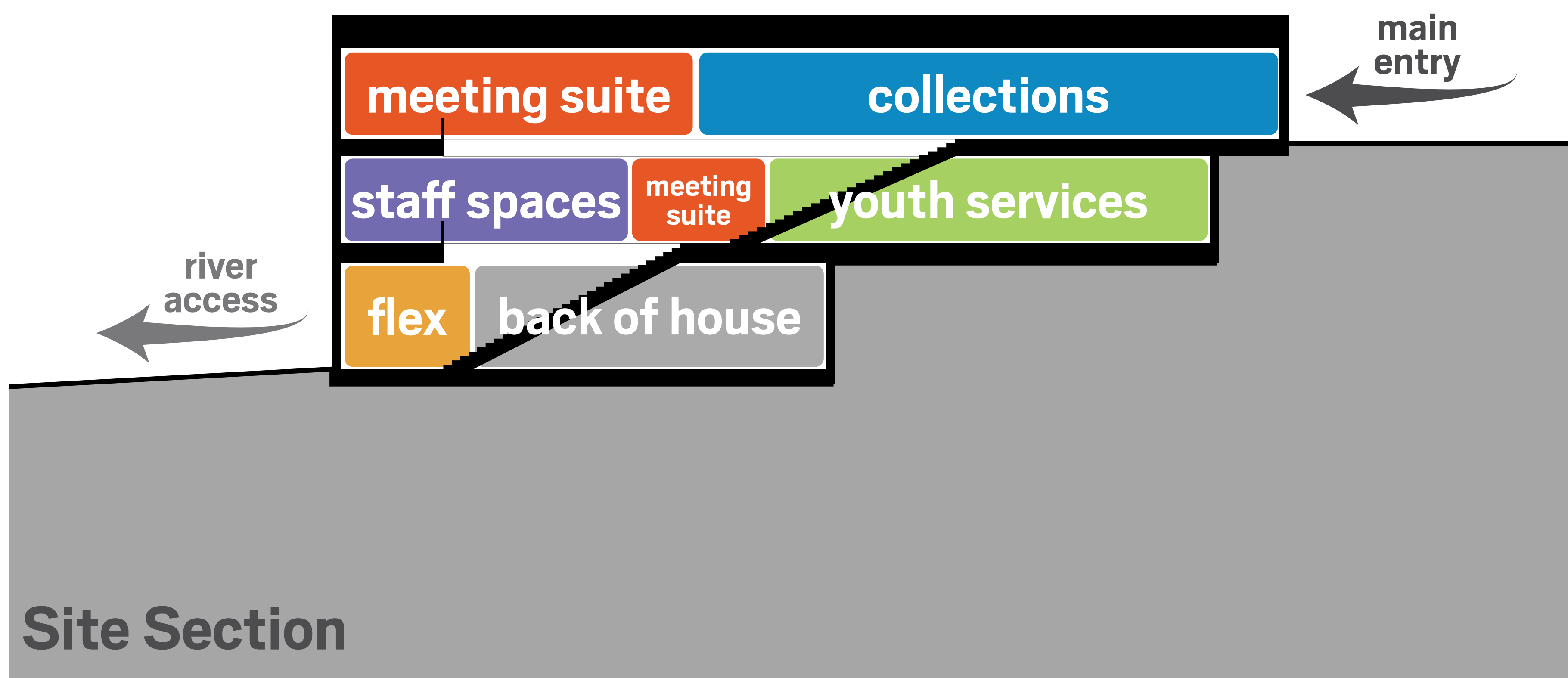

feedback

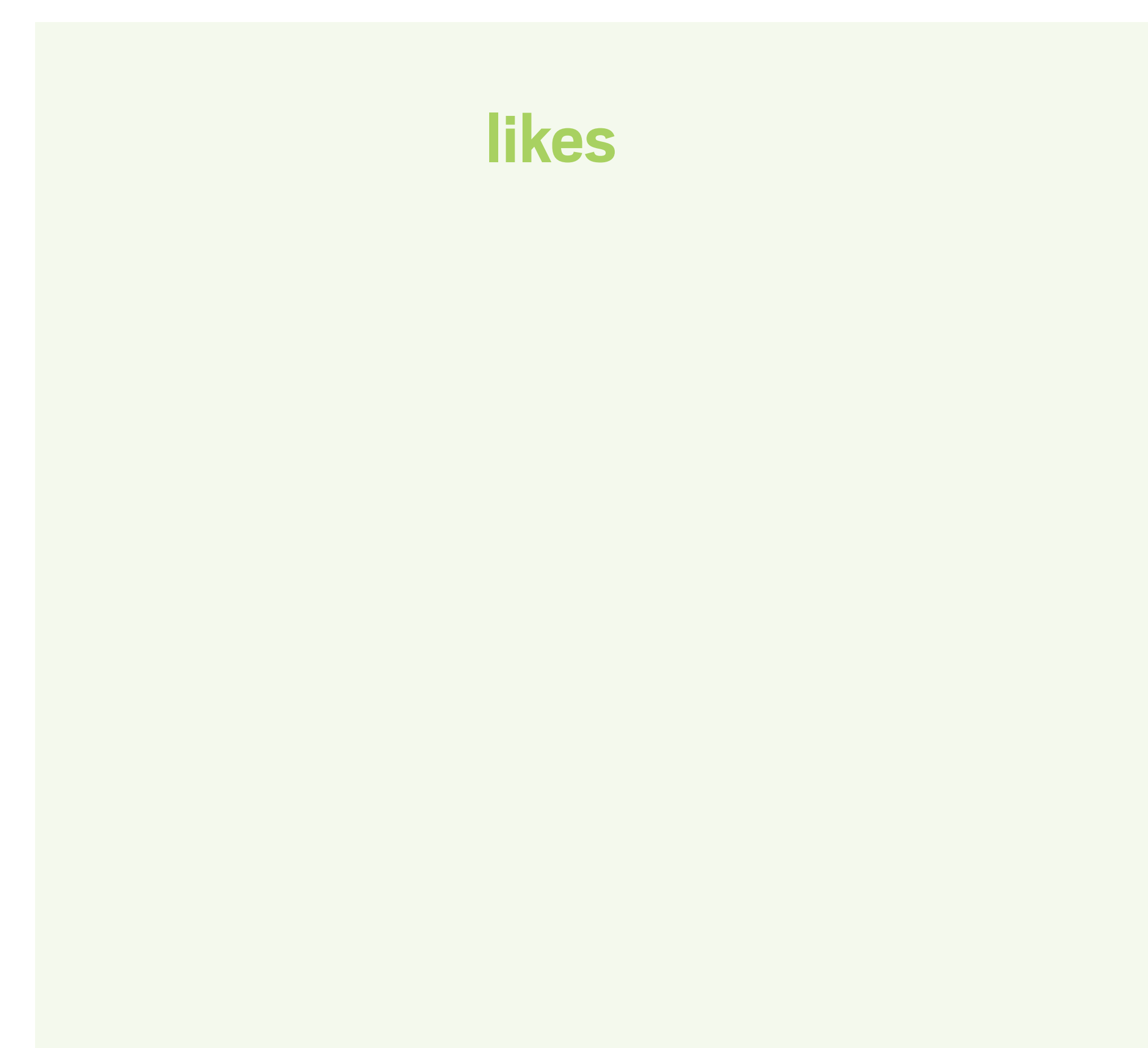

likes

concept study - we'd like to hear from you!

Strategies for Nashua Public Library - Replacement

As part of its re-imagining, the Library Board of Trustees would like to take your needs and feedback into consideration. Let us know what you think!

instructions

Leave us a sticky note with any feedback you have on this scheme. Then come back and place 'likes' (sticky dots) on the schemes you like the best.

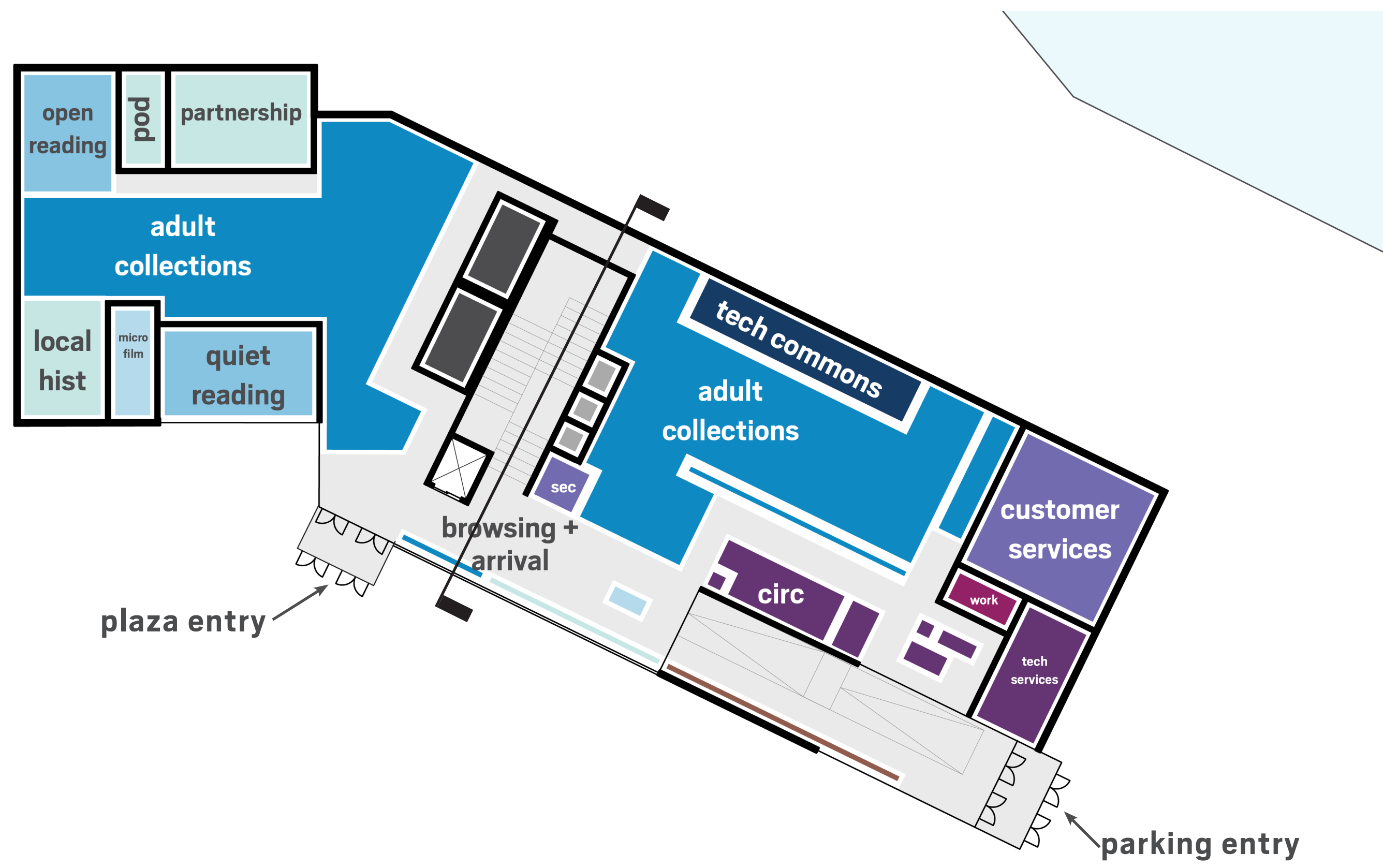

Level 2 (Main Entry)

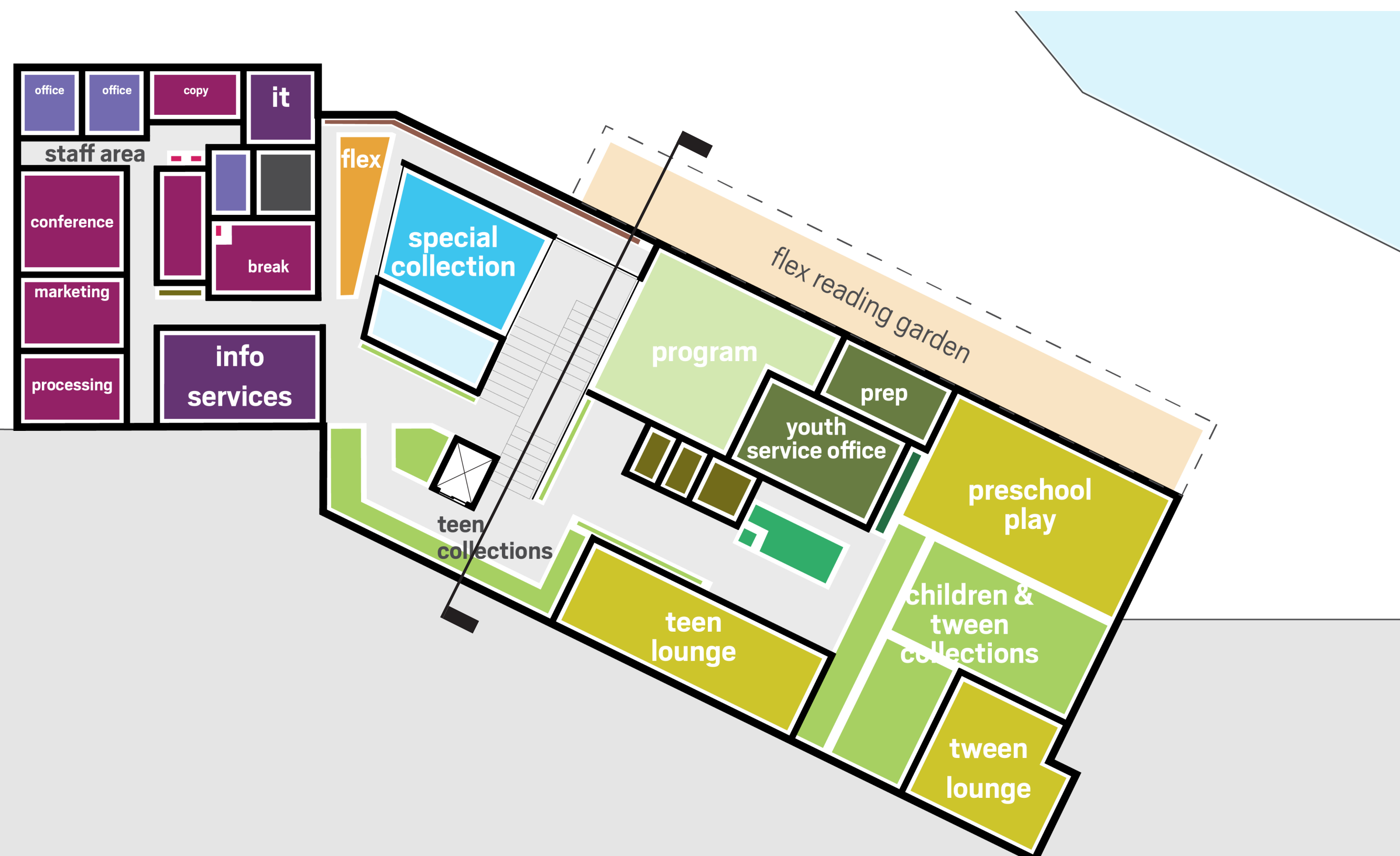

Level 1

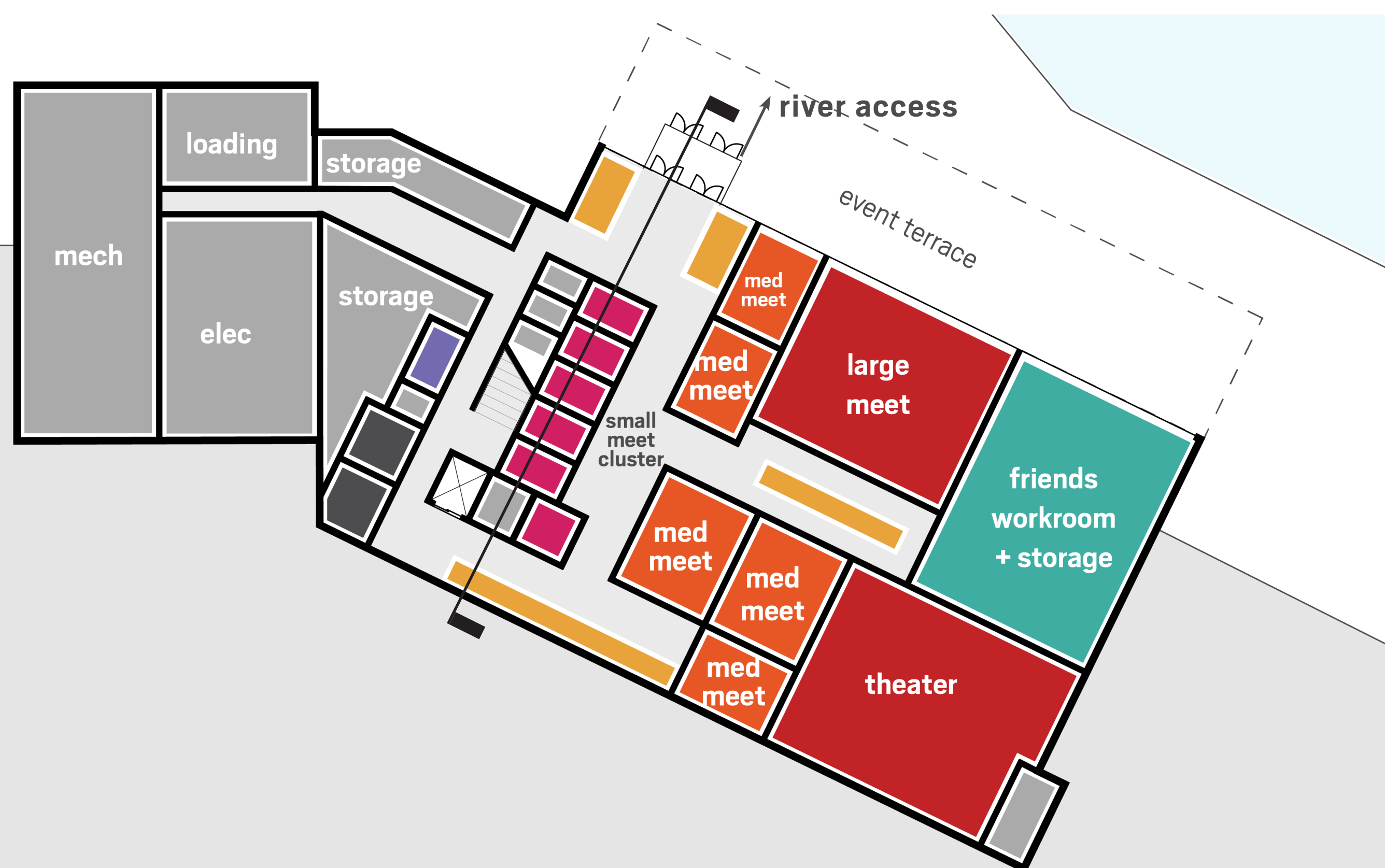

Basement

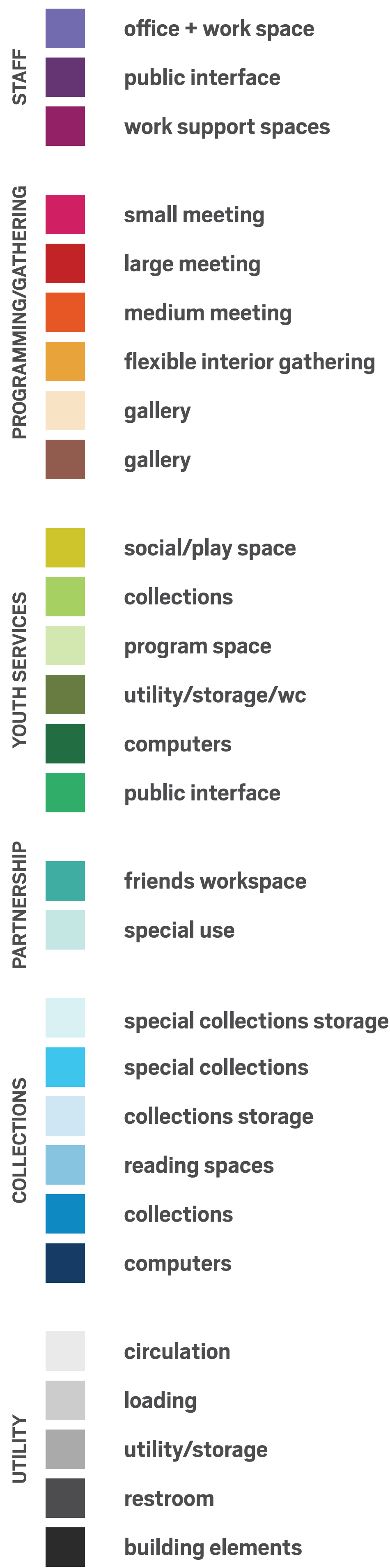

Key Considerations

- Existing building is demolished entirely and a new building is built in its place
- New dual entry sequence from parking lot and plaza is created
- Creation of a centralized circulation zone throughout all floors.
- Centralized Staff Offices
- New exterior building expression (glass + cladding), opening the building to the exterior
- Library collection is immediately visible and accessible upon entering
- Youth Services is expanded and located on middle level with outdoor river overlook
- Lowest / river level is activated as a community event + program destination
- Requires a change of parking strategy

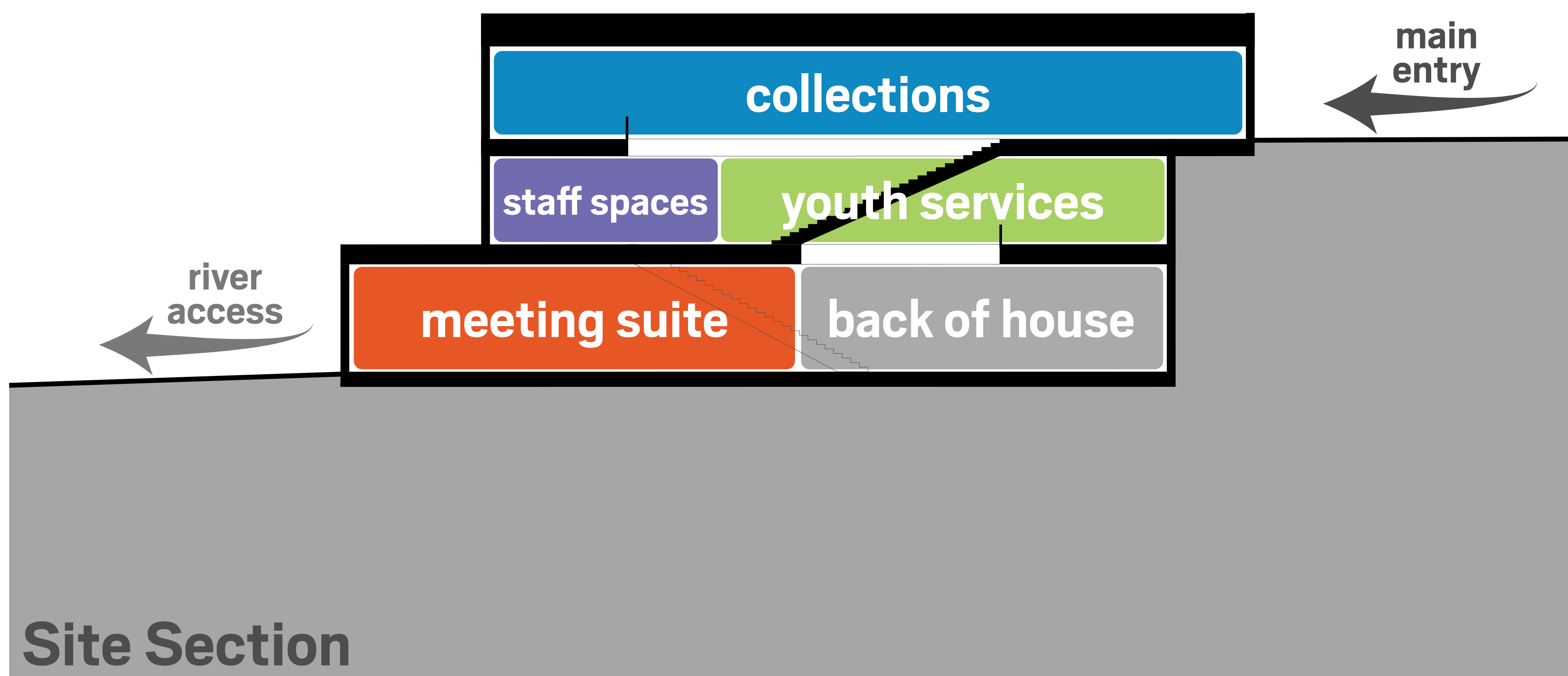

Site Section

feedback

likes

concept study - we'd like to hear from you!

Strategies for Nashua Public Library - Relocation

As part of its re-imagining, the Library Board of Trustees would like to take your needs and feedback into consideration. Let us know what you think!

instructions

Leave us a sticky note with any feedback you have on this scheme. Then come back and place 'likes' (sticky dots) on the schemes you like the best.

Level 3



Level 2

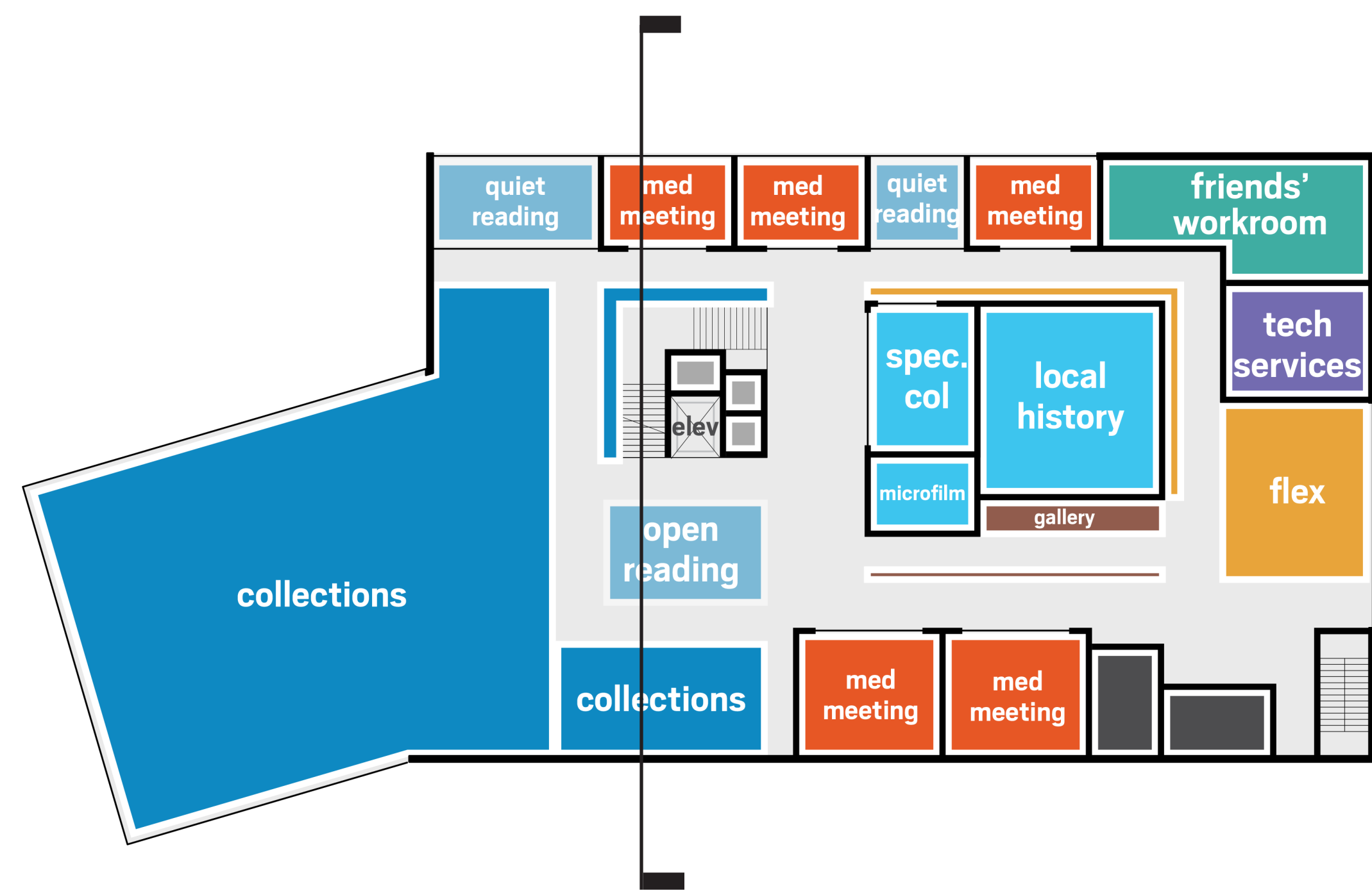

Level 1 (Main Entry)

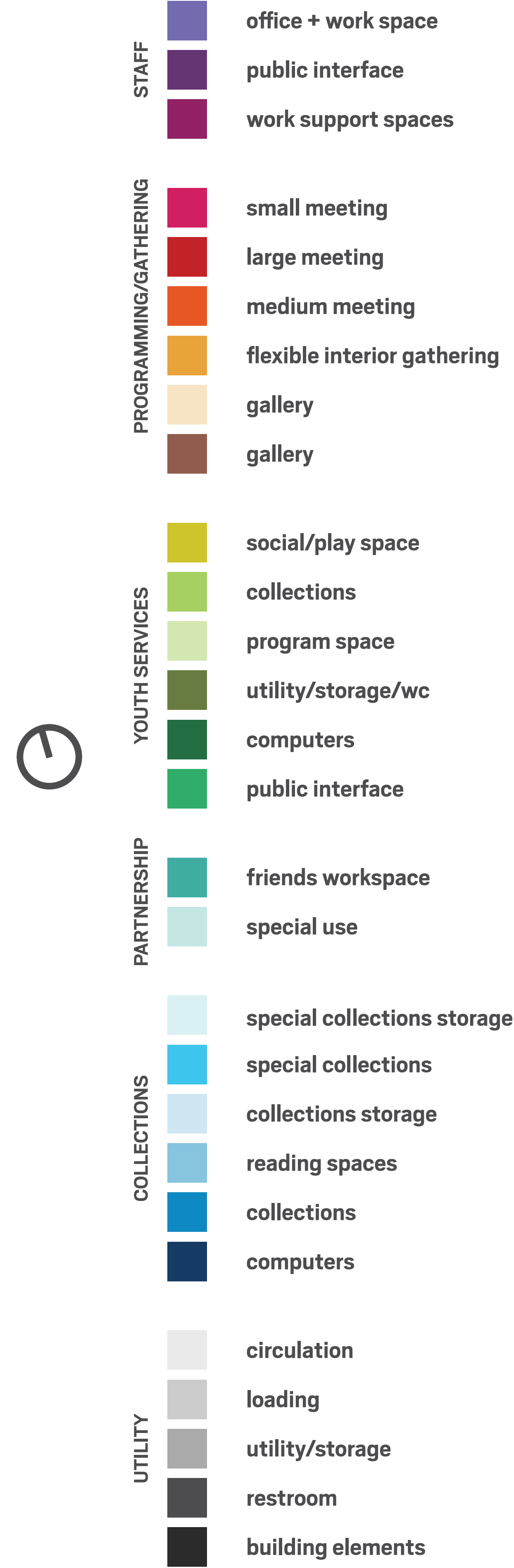
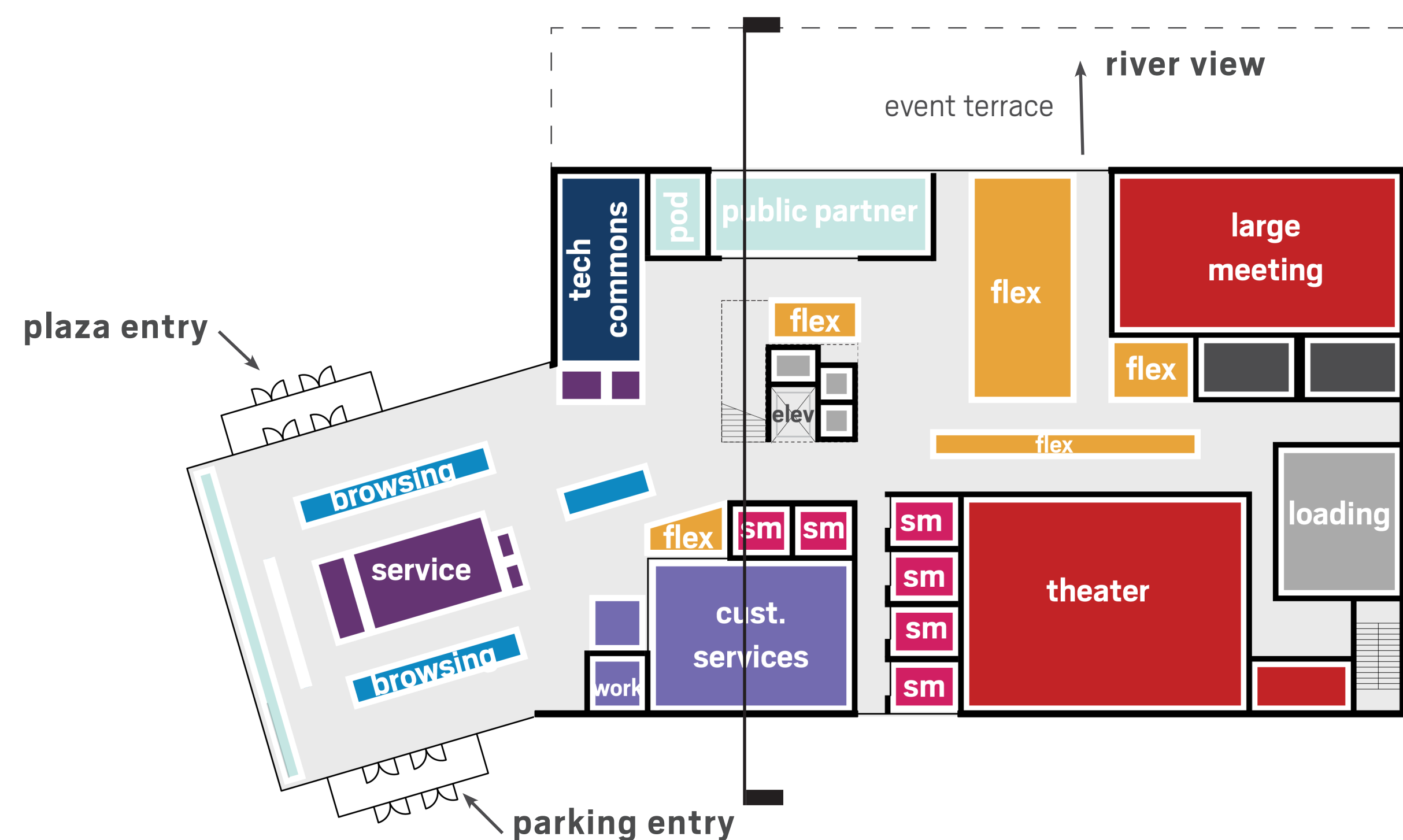

Key Considerations

- Existing building is demolished entirely and site is repurposed
- A new building is constructed on adjacent parking lot
- Building entry is prominently located adjacent to parking and plaza
- Entry level can be utilized as community event + program venue with outdoor terrace
- Youth Services is expanded and located on upper level
- Building sits higher in relation to the river
- Opportunity for continuity of Library Services
- Highest environmental impact (lose embodied carbon of existing building)

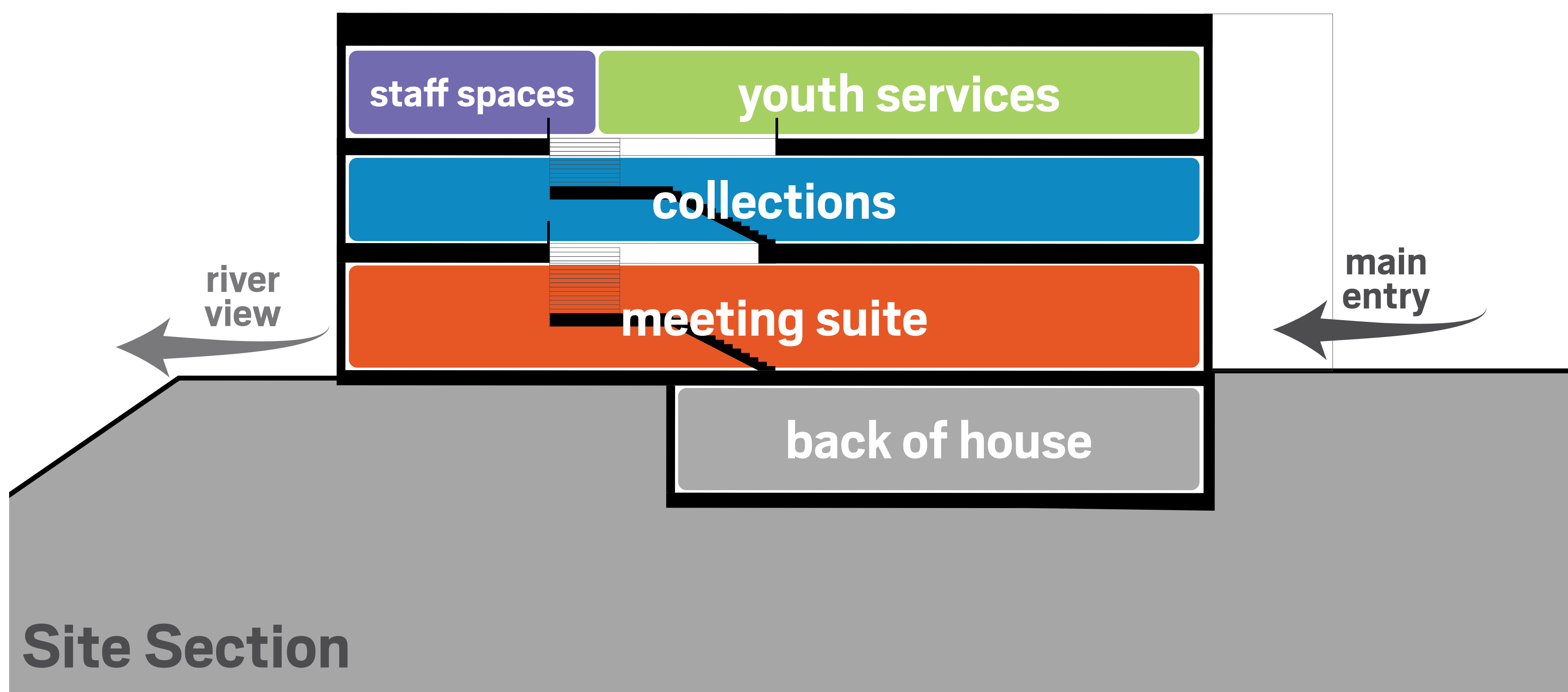

feedback

likes